

BIHAN 6.50

Fast, elegant and easy

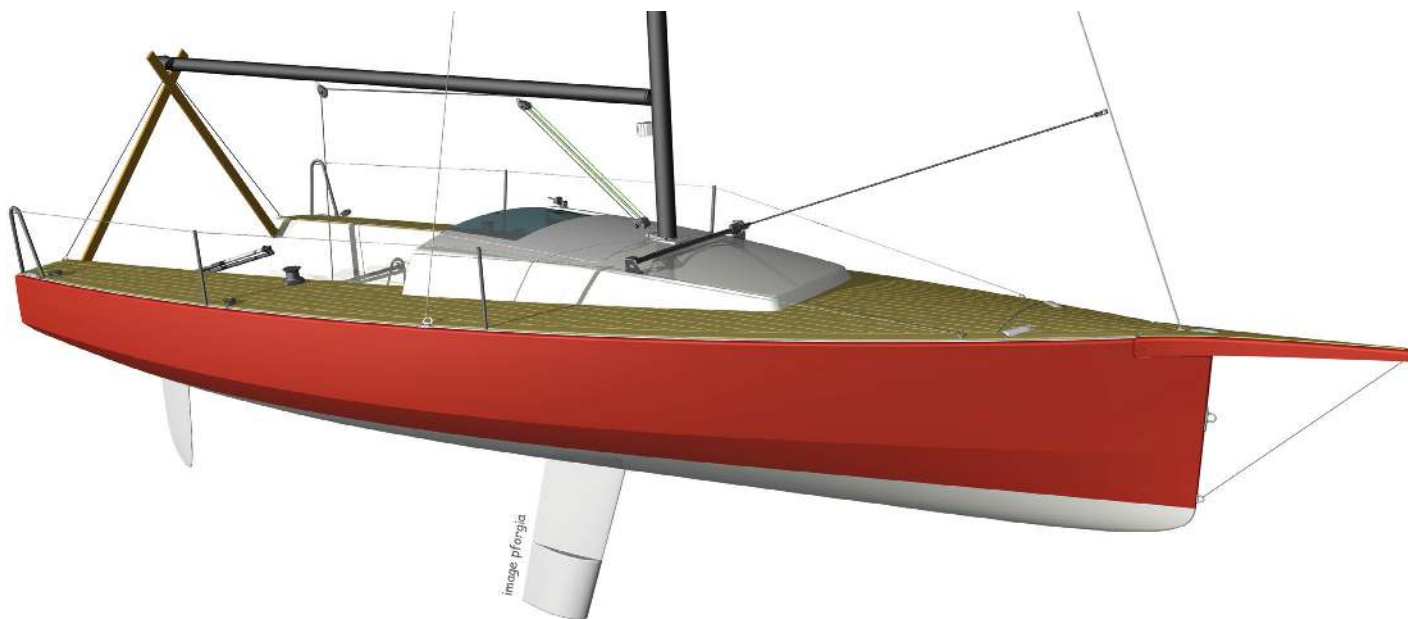

 **marine
composite**

finot-conq
ARCHITECTES

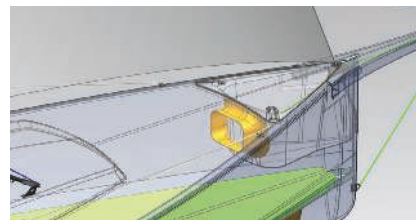
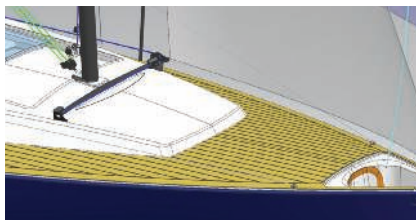
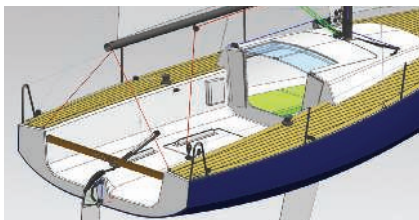

Bihan 6.50 perfectly embodies the pleasures of an easy-to-use family day boat but can also be used with a crew of two or even single-handed. This rapid and elegant boat can be sailed in perfect safety for a picnic on an island, a short day trip or a friendly regatta and her cabin will accommodate up to four adults for a few nights on board.

Fast

Up-to-the-minute hull shape
Hull and deck in sandwich infusion
Carbon fiber rig
Light displacement
Lead keel bulb

Elegant

Gunter rig
Teak-like deck
Color of your choice
Both classic and modern

Easy

Self-tacking jib
Spinnaker snuffer
Mast stepping by only one person
Keel lifts inside hull entirely
Trailerable

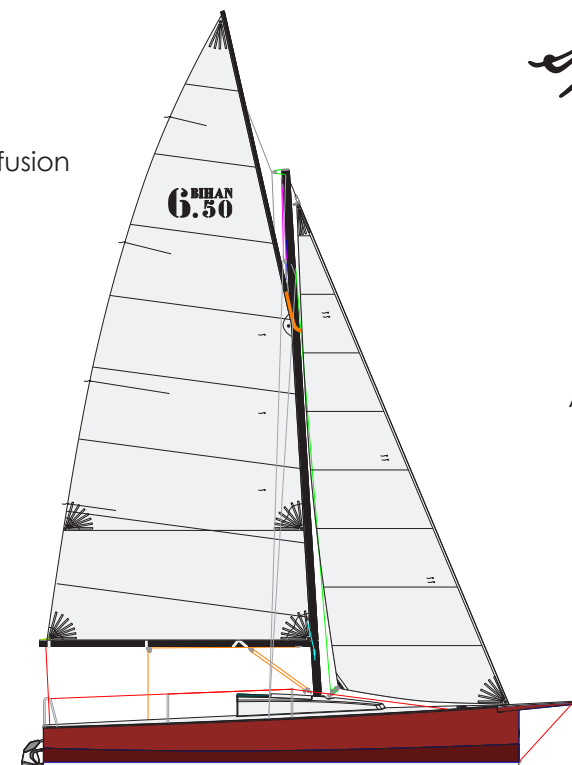

Specifications

Hull length: 6.50m
Beam: 2.54m
Draft: 0.20/1.30m
Displacement: 800kg
Mainsail: 19m²
Jib on stocker: 8.50m²
Asymmetrical spinnaker: 30m²
Berths: 4
Engine: 4HP outboard
Design category:
Cat. C: 4 pax
Cat. D: 6 pax



Boat Manufacturer since 1996

Zone Artisanale du Redo
Port du Crouesty - 56640 Arzon - France
T : +33(0)2 97 53 68 21
commercial@marinecomposite.fr
www.marinecomposite.fr